

SOUTH PARK MALL

2310 SW Military Dr. San Antonio, TX 78244

PROPERTY

HIGHLIGHTS

Demographics	1 mile	3 miles	5 miles
Population	12,921	112,706	241,365
Avg. HH Income	\$62,566	\$72,499	\$66,838
Total Households	4,185	36,803	80,047

- Located at the Intersection of I-35 and SW Military Drive
- Ideally Situated in a highly visible and easily accessible location in South San Antonio
- Positioned in a heavily-trafficked area with traffic counts exceeding 137,000 VPD

NOTES

ANCHORS

- **GLA: 783,978 SF**
- **Availabilities: Former Sears**
- **Traffic Counts:** 21,765 VPD South West Military Drive
22,028 VPD S. Zarzamora Street
72,457 VPD I-35

- **Macy's, JC Penney, Dick's, Shoppers World, Fitness Connection, Ulta & Old Navy**



MASON
ASSET MANAGEMENT

T: 516 371.5858
E: leasing@masonam.com
150 Great Neck Road Suite 402
Great Neck, NY, 11021
www.masonam.com

SOUTH PARK MALL

2310 SW Military Dr. San Antonio, TX 78244

SITE PLAN

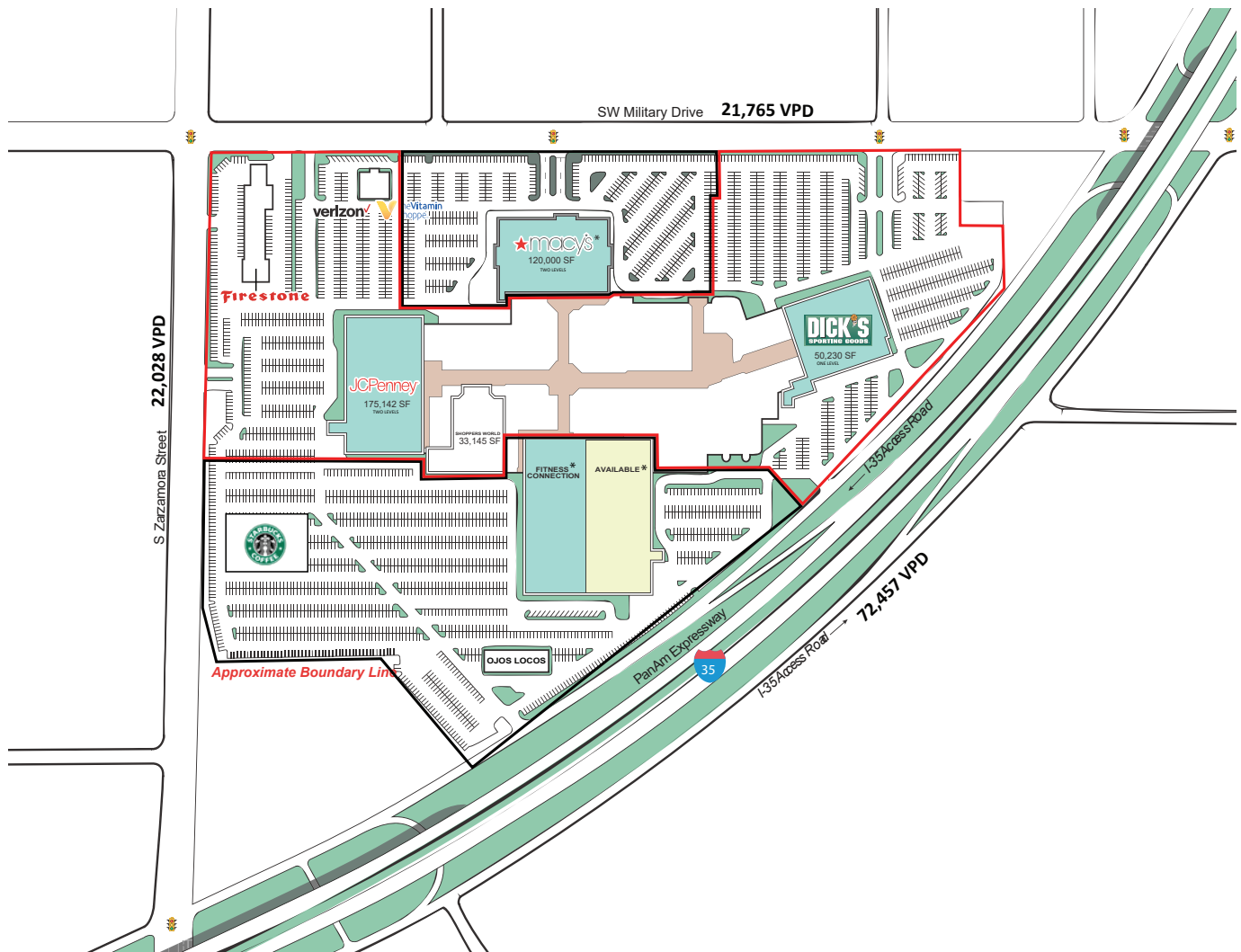

*NOT OWNED



MASON
ASSET MANAGEMENT

T: 516 371.5858
E: leasing@masonam.com
150 Great Neck Road Suite 402
Great Neck, NY, 11021
www.masonam.com

SOUTH PARK MALL

2310 SW Military Dr. San Antonio, TX 78244

LEASE PLAN

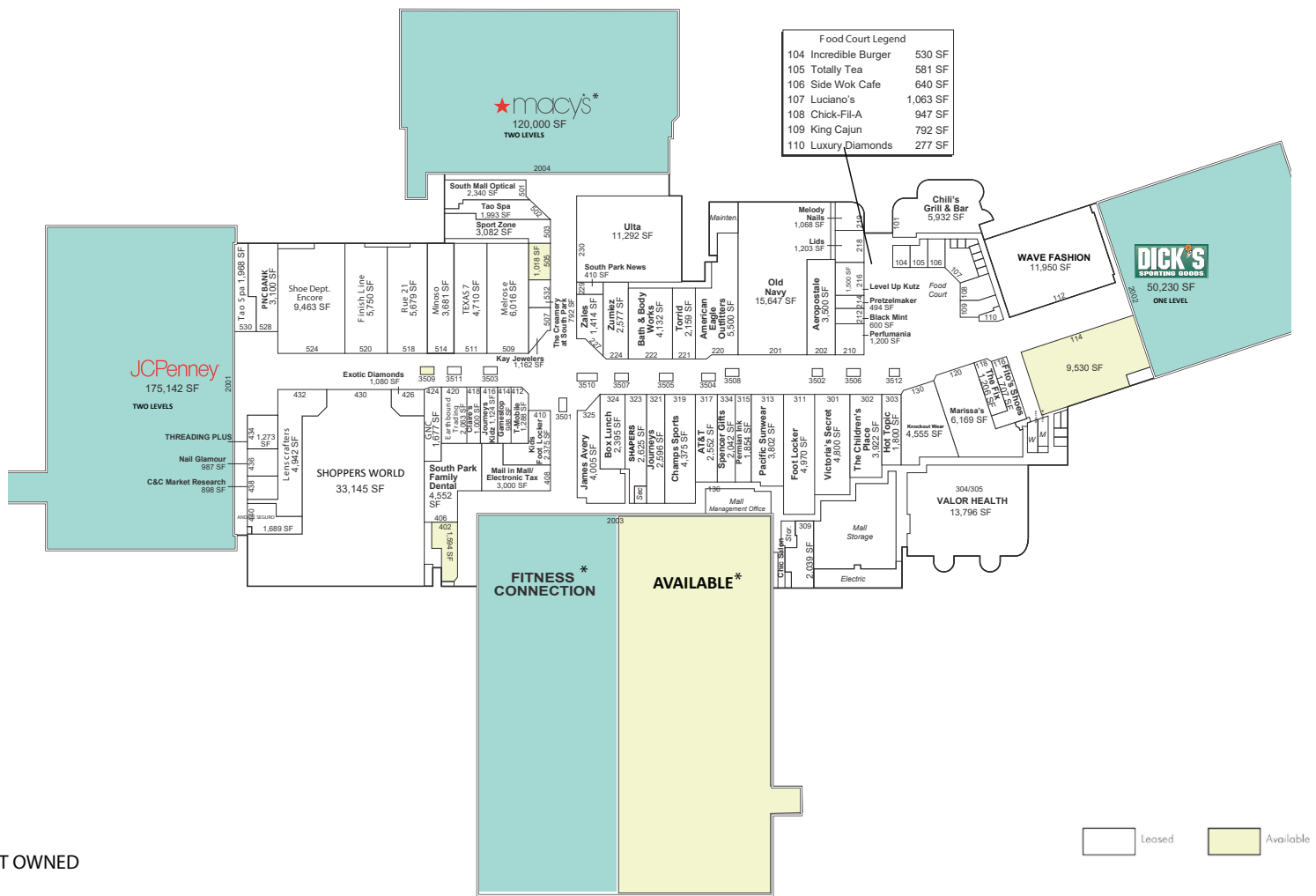

*NOT OWNED

Leased Available



MASON
ASSET MANAGEMENT

T: 516 371.5858
E: leasing@masonam.com
150 Great Neck Road Suite 402
Great Neck, NY, 11021
www.masonam.com

SOUTH PARK MALL

2310 SW Military Dr. San Antonio, TX 78244

RETAILER MAP



MASON
ASSET MANAGEMENT

T: 516 371.5858
E: leasing@masonam.com
150 Great Neck Road Suite 402
Great Neck, NY, 11021
www.masonam.com

SOUTH PARK MALL

2310 SW Military Dr. San Antonio, TX 78244

RADIUS MAP

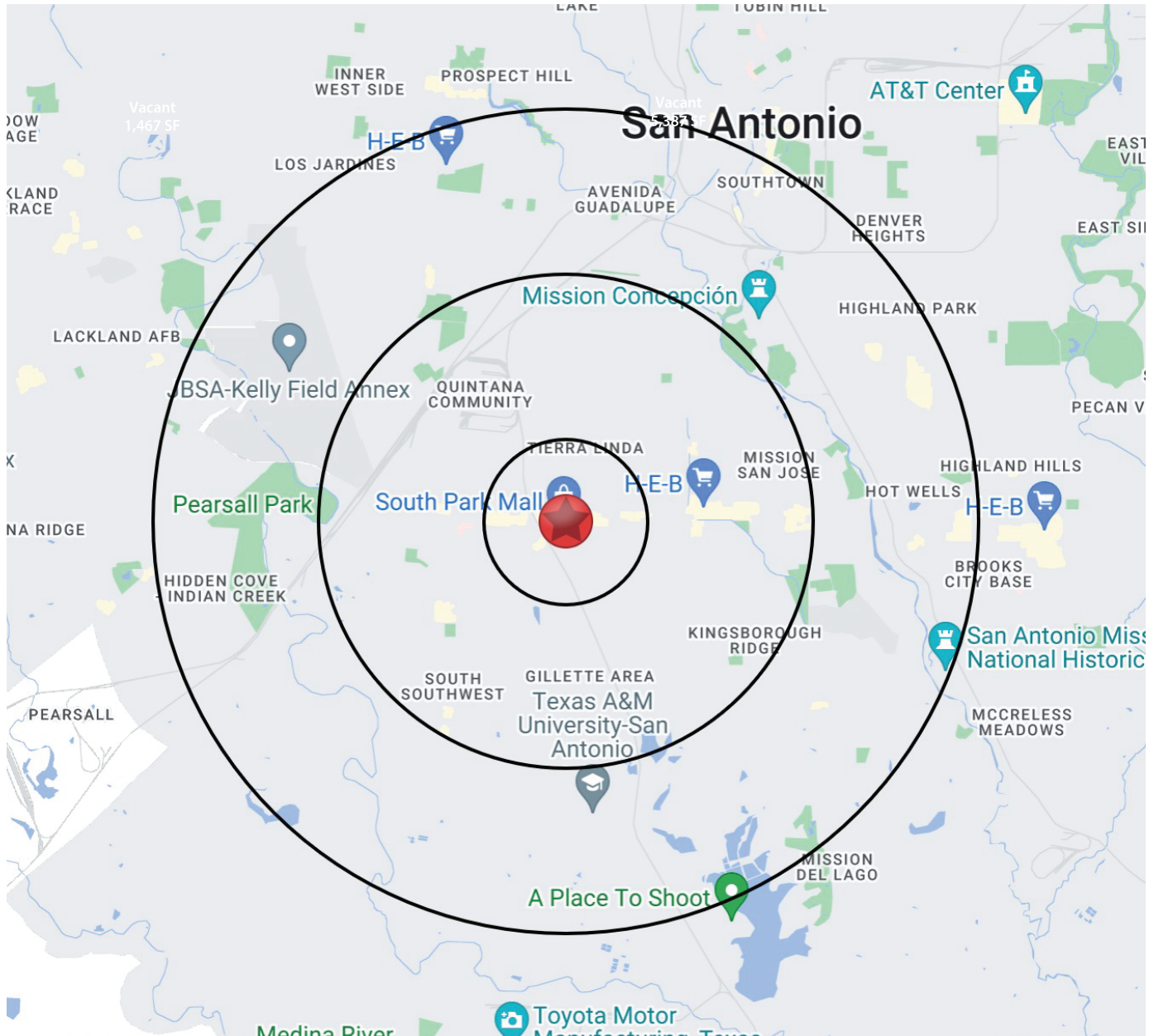

MASON
ASSET MANAGEMENT

T: 516 371.5858
E: leasing@masonam.com
150 Great Neck Road Suite 402
Great Neck, NY, 11021
www.masonam.com