

TRUMBULL MALL

5065 Main Street, Trumbull, CT 06611

PROPERTY

HIGHLIGHTS

Demographics	1 mile	3 miles	5 miles
Population	11,137	97,063	248,309
Avg. HH Income	\$115,463	\$126,460	\$122,859
Total Households	3,945	34,185	89,864

- Adjacent to newly built 260 unit multi-family complex
- Located just off Merritt Parkway 10 miles west of New Haven, CT
- Located in fastest growing county in Connecticut - Fairfield county

NOTES

NOTABLE TENANTS

- GLA: 1,130,690 SF
- Availabilities: Anchor, Inline
- Traffic Count: 72,897 VPD Merritt Pkwy
18,949 VPD Main Street

- JCPenney, Target, Macy's & LA Fitness



MASON
ASSET MANAGEMENT

T: 516 371.5858
E: leasing@masonam.com
747 Middle Neck Road Suite 101
Great Neck, NY, 11024
www.masonam.com

TRUMBULL MALL

5065 Main Street, Trumbull, CT 06611

SITE PLAN

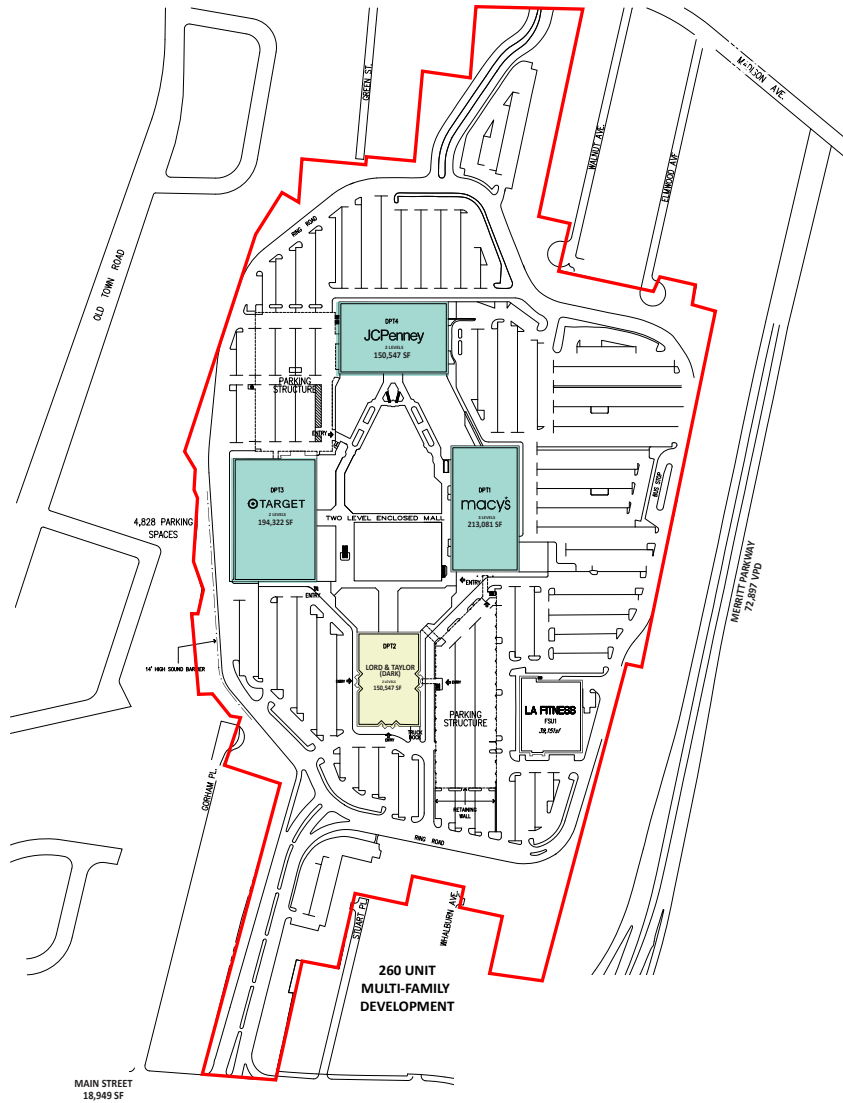

Leased Available



MASON
ASSET MANAGEMENT

T: 516 371.5858
E: leasing@masonam.com
747 Middle Neck Road Suite 101
Great Neck, NY, 11024
www.masonam.com

TRUMBULL MALL

5065 Main Street, Trumbull, CT 06611

LEASE PLAN UPPER LEVEL

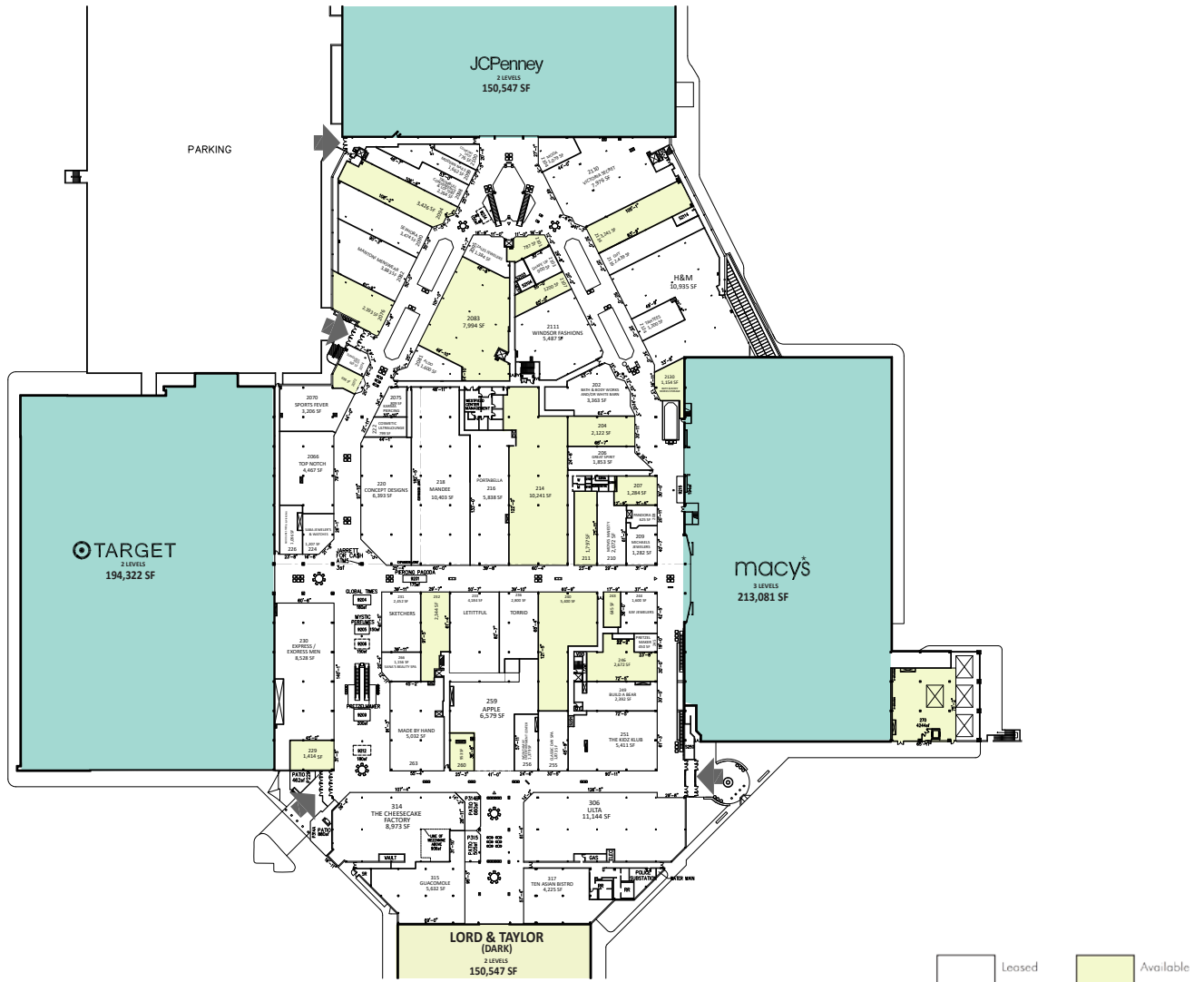

MASON
ASSET MANAGEMENT

T: 516 371.5858
E: leasing@masonam.com
747 Middle Neck Road Suite 101
Great Neck, NY, 11024
www.masonam.com

TRUMBULL MALL

5065 Main Street, Trumbull, CT 06611

LEASE PLAN LOWER LEVEL

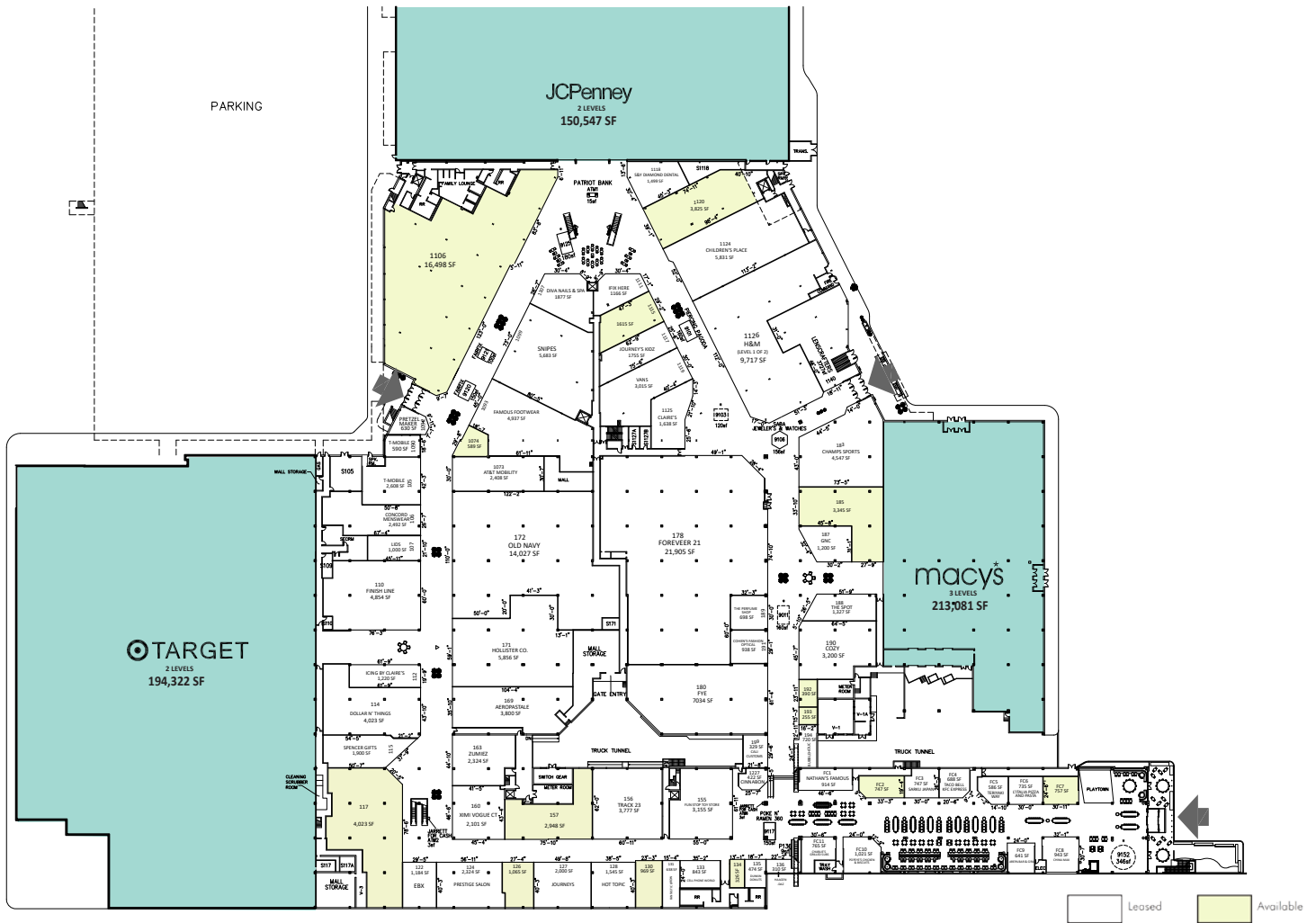

TRUMBULL MALL

5065 Main Street, Trumbull, CT 06611

RETAILER MAP



MASON
ASSET MANAGEMENT

T: 516 371.5858
E: leasing@masonam.com
747 Middle Neck Road Suite 101
Great Neck, NY, 11024
www.masonam.com

TRUMBULL MALL

5065 Main Street, Trumbull, CT 06611

RADIUS MAP

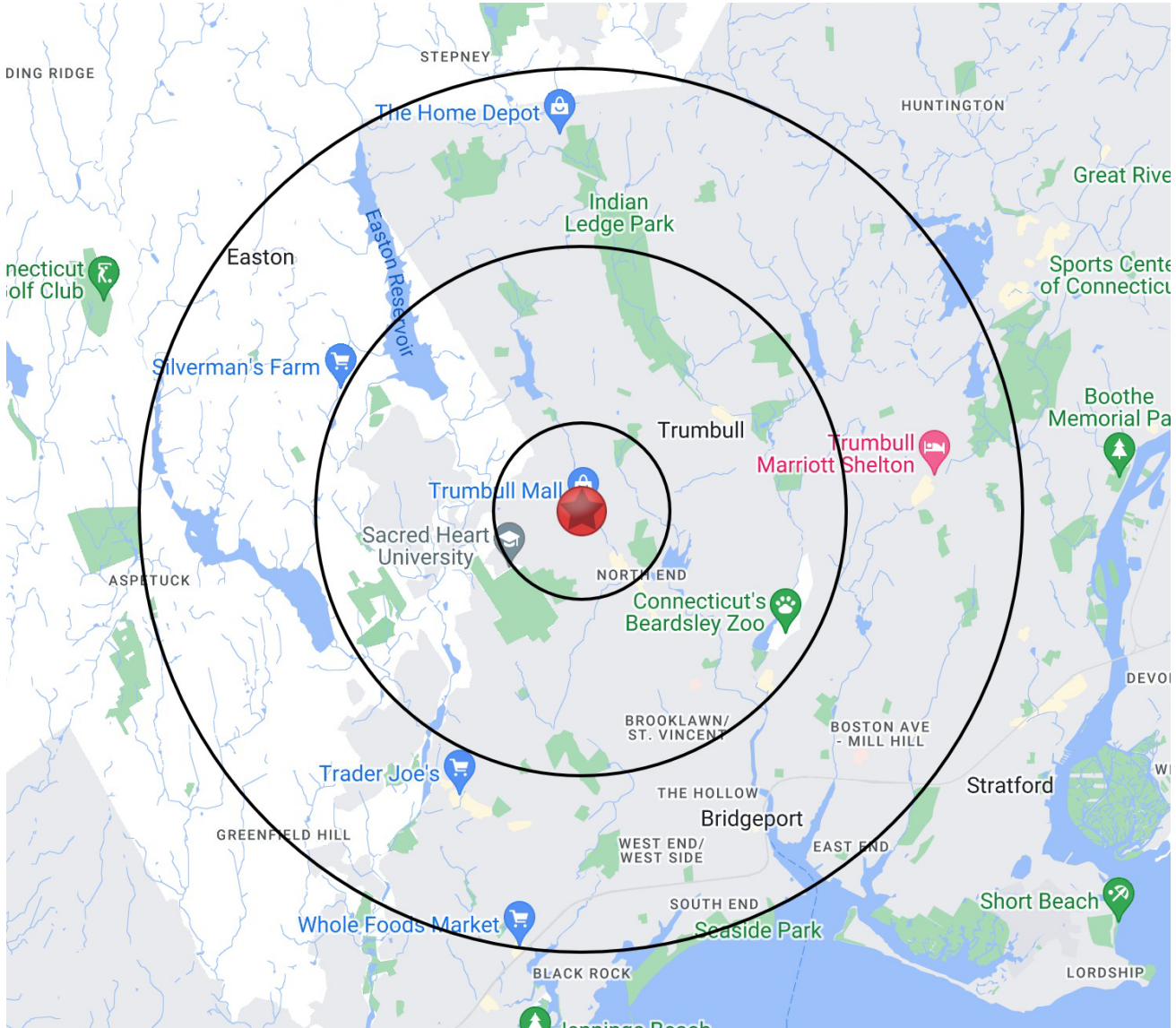

MASON
ASSET MANAGEMENT

T: 516 371.5858
E: leasing@masonam.com
747 Middle Neck Road Suite 101
Great Neck, NY, 11024
www.masonam.com